

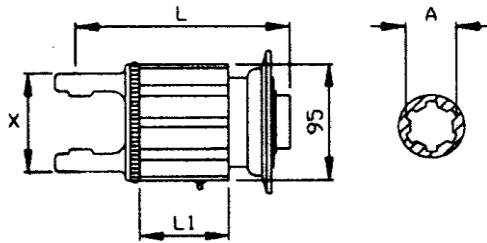

### Radial Pin Clutch with Q.D. Lock, Ball Type



Independent Rotation

Shaft Size		Clutch	Row	Torque	L 1	L	X	A	Part No.
Series #1	22 X 54	<b>N 1</b> <b>N 2</b>	1 2	300 600	38 57	119 138	73	1.3/8"-6	8-N1L0138030 8-N2L0138060
Series #2	23.8 X 61.3	<b>N 1</b> <b>N 2</b> <b>N 3</b>	1 2 3	300 600 900	38 57 76	119 138 157			8-N1L0238030 8-N2L0238060 8-N3L0238090
Series #3 *	27 X 70	<b>N 2</b> <b>N 3</b>	2 3	600 900	57 76	142 161			8-N2B0338060 8-N3B0338090
Series #4	27 x 74.6	<b>N 2</b> <b>N 3</b> <b>N 4</b>	2 3 4	600 900 1200	57 76 95	142 161 180	8-N2L0438060 8-N3L0438090 8-N4L0438120		
Series #5	30.2 x 80	<b>N 3</b> <b>N 4</b> <b>N 5</b>	3 4 5	900 1200 1500	76 95 114	165 184 203	8-N3B0538090 8-N4B0538120 8-N5B0538150		
Series 35	30.2 x 92	<b>N 3</b> <b>N 4</b> <b>N 5</b>	3 4 5	900 1200 1500	76 95 114	171 190 209	8-N3B0638090 8-N4B0638120 8-N5B0638150		

\*Type phase out

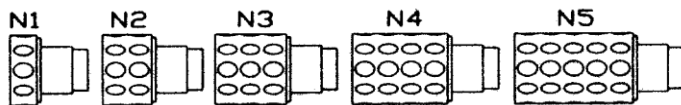

Clutch	Holes
N1	8
N2	16
N3	24
N4	32
N5	40

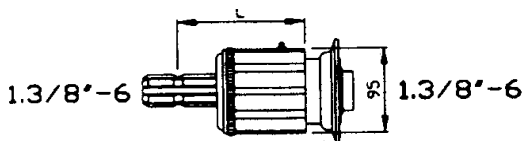

	<b>NM1</b> L=146	<b>NM2</b> L=165	<b>NM3</b> L=184	<b>NM4</b> L=203
Part No.	8-NM138030	8-NM238060	8-NM338090	8-NM438120